

Hi!
I am
A.I. LOVE YOU

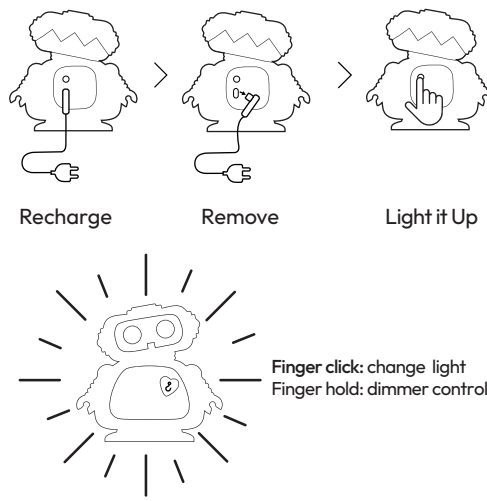

Size
H.25Cm W.12.5cm x D.26.5Cm

REDHOOK S.R.L.
info@redhooklab.com
www.redhooklab.com

Weight

1kg

Materials

PE - Polyethylene

Light

120Lumen Integrated rechargeable lithium battery

Characteristics

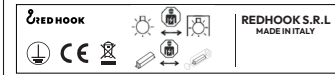

WARNING: The safety of the appliance is guaranteed by the proper use of the following instructions, which must be retained. If accessories (i.e. cables - chargers or similar) or electrical components (i.e. light-transformers or similar) are damaged, they must be only replaced by the manufacturer, its service department or equivalent qualified personnel in order to avoid danger.
The product has IP44
DISPOSAL: RAEE (EU Directive 2012/19/EU)
The product must be disposed to separate collection.
Red Hook products are largely made of recyclable material.
Contact the waste collection agency, or ask the seller.

Hi!
I am
A.I. LOVE YOU

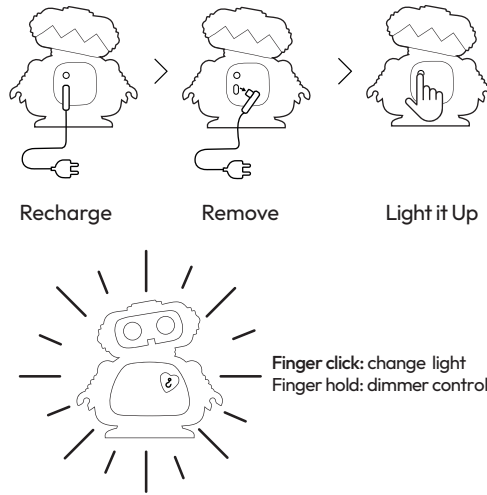

Size
H.25Cm W.12.5cm x D.26.5Cm

REDHOOK S.R.L.
info@redhooklab.com
www.redhooklab.com

Weight

1kg

Materials

PE - Polyethylene

Light

120Lumen Integrated rechargeable lithium battery

Characteristics

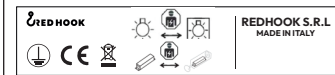

WARNING: The safety of the appliance is guaranteed by the proper use of the following instructions, which must be retained. If accessories (i.e. cables - chargers or similar) or electrical components (i.e. light-transformers or similar) are damaged, they must be only replaced by the manufacturer, its service department or equivalent qualified personnel in order to avoid danger.
The product has IP44
DISPOSAL: RAEE (EU Directive 2012/19/EU)
The product must be disposed to separate collection.
Red Hook products are largely made of recyclable material.
Contact the waste collection agency, or ask the seller.

Hi!
I am
A.I. LOVE YOU

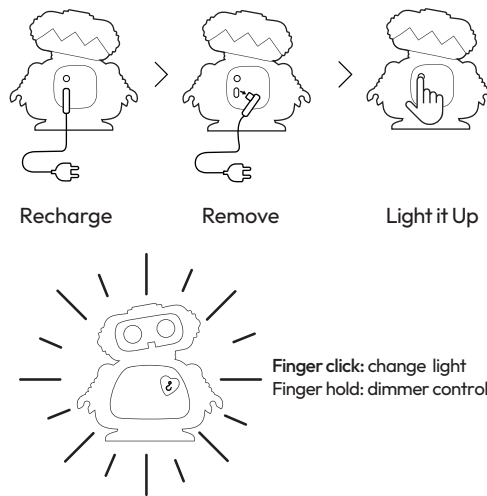

Size
H.25Cm W.12.5cm x D.26.5Cm

REDHOOK S.R.L.
info@redhooklab.com
www.redhooklab.com

Weight

1kg

Materials

PE - Polyethylene

Light

120Lumen Integrated rechargeable lithium battery

Characteristics

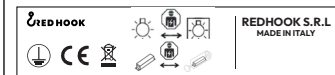

WARNING: The safety of the appliance is guaranteed by the proper use of the following instructions, which must be retained. If accessories (i.e. cables - chargers or similar) or electrical components (i.e. light-transformers or similar) are damaged, they must be only replaced by the manufacturer, its service department or equivalent qualified personnel in order to avoid danger.
The product has IP44
DISPOSAL: RAEE (EU Directive 2012/19/EU)
The product must be disposed to separate collection.
Red Hook products are largely made of recyclable material.
Contact the waste collection agency, or ask the seller.

Hi!
I am
A.I. LOVE YOU

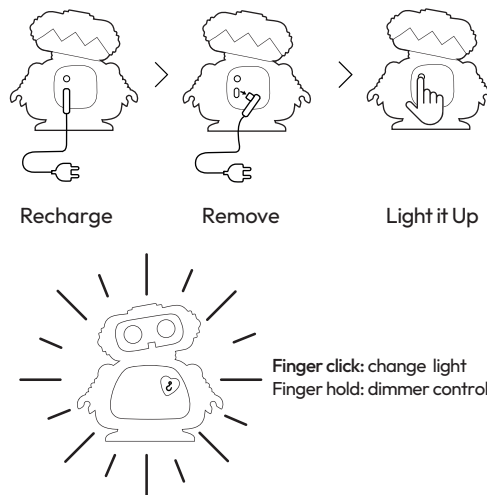

Size
H.25Cm W.12.5cm x D.26.5Cm

REDHOOK S.R.L.
info@redhooklab.com
www.redhooklab.com

Weight

1kg

Materials

PE - Polyethylene

Light

120Lumen Integrated rechargeable lithium battery

Characteristics

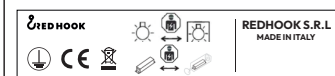

WARNING: The safety of the appliance is guaranteed by the proper use of the following instructions, which must be retained. If accessories (i.e. cables - chargers or similar) or electrical components (i.e. light-transformers or similar) are damaged, they must be only replaced by the manufacturer, its service department or equivalent qualified personnel in order to avoid danger.
The product has IP44
DISPOSAL: RAEE (EU Directive 2012/19/EU)
The product must be disposed to separate collection.
Red Hook products are largely made of recyclable material.
Contact the waste collection agency, or ask the seller.